

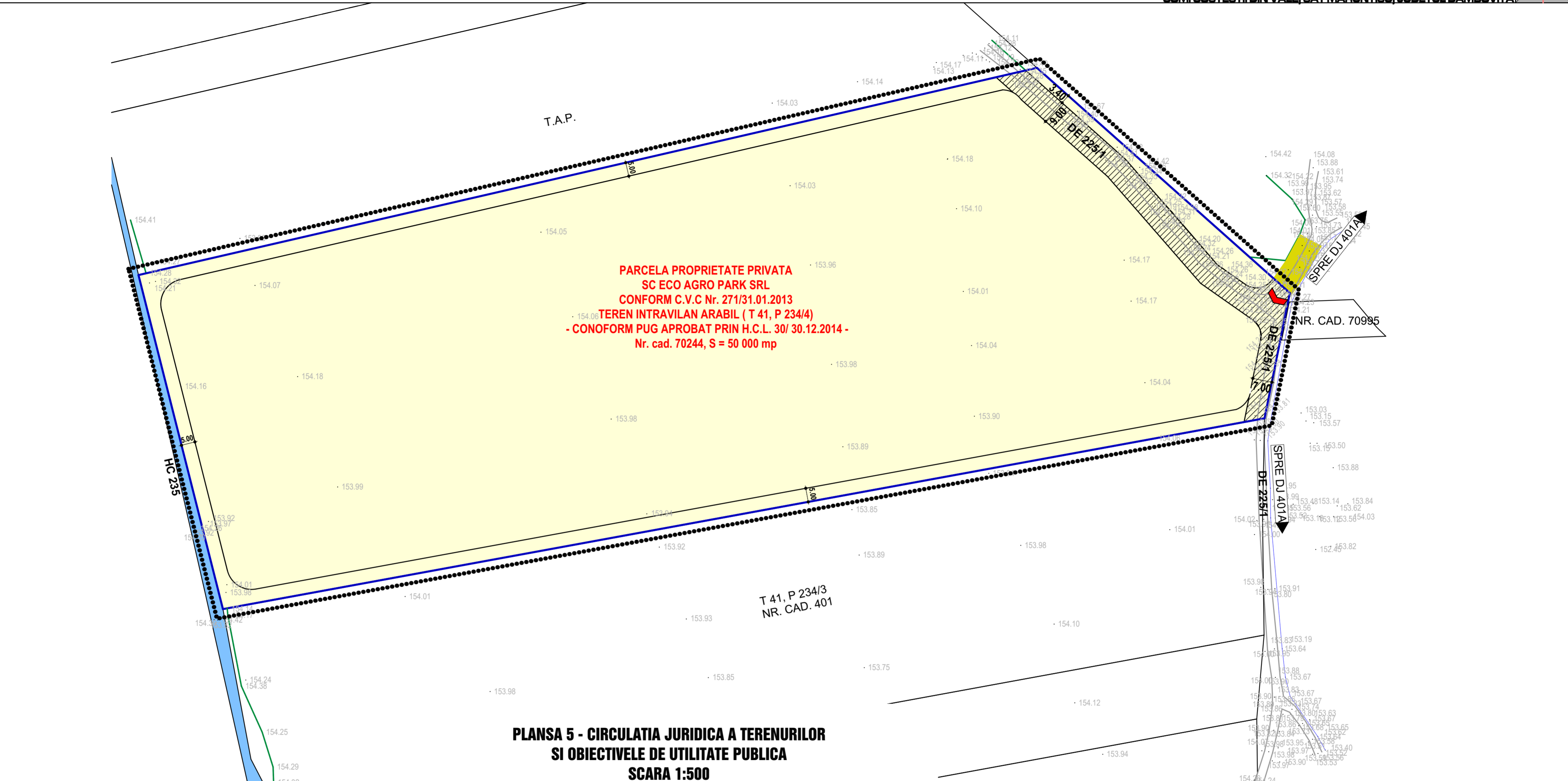





PLAN URBANISTIC ZONAL

CONSTRUIRE CENTRALA FOTOVOLTAICA SI RACORDAREA LA REEA
 CU PUTEREA INSTALATA DE 4224 kWp, AMPLASATA LA SOL
 SC ECO AGRO PARK SRL
 COM. COSTESTI DIN VALE, SAT MARUNTISU, JUDETUL DAMBOVITA

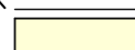

**PLANSĂ 5 - CIRCULATIA JURIDICA A TERENURILOR SI OBIECTIVELE DE UTILITATE PUBLICA
 SCARA 1:500**

-  LIMITA ZONEI STUDIATE IN PREZENTA DOCUMENTATIE
-  LIMITA CADASTRALA A PARCELELOR PROPRIETATE PUBLICA PRIVATA
- TERENURI PROPRIETATE PUBLICA DE INTERES LOCAL**
-  TEREN CE APARTINE DOMENIULUI PUBLIC SAU PRIVAT
- TERENURI PROPRIETATE PUBLICA PRIVATA**
-  PARCELA AFLATA IN PROPRIETATEA PRIVATA ,TEREN INTRAVILAN
- CIRCULATIA JURIDICA A TERENURILOR**
-  SUPRAFATA TEREN CE URMEAZA A TRECE IN DOMENIUL PUBLIC PENTRU LARGIRE SI MODERNIZARE DRUMURI EXISTENTE, REALIZARE DRUMURI NOI

 ARCHITECTURE SRL TARGOVISTE, B-dul L.C. BRATIANU, NR. 27B, JUDETUL DAMBOVITA, ROMANIA telefon 0345 401 280, fax 0345 401 281, e-mail: architecture_tgv@yahoo.com	CONSTRUIRE CENTRALA FOTOVOLTAICA SI RACORDAREA LA REEA CU PUTEREA INSTALATA DE 4224 kWp, AMPLASATA LA SOL Amplasament: Comuna Costesti din Vale, Sat Maruntisu, Jud Dambovita Beneficiari: SC ECO AGRO PARK SRL				
	Sef proiect	arh. Razvan Nitescu	SCARA 1:500	CIRCULATIA JURIDICA A TERENURILOR SI OBIECTIVELE DE UTILITATE PUBLICA PLANSĂ NR. 4	PR. NR. 18/2021 FAZA PUZ
	Proiectat	arh. Luchian Nitescu			
	Redactat	ing. Lucian Rusu	DATA 11.2021		
Verificat	arh. Dan Nitescu				